

A389 Fitting Instructions

Components Checklist

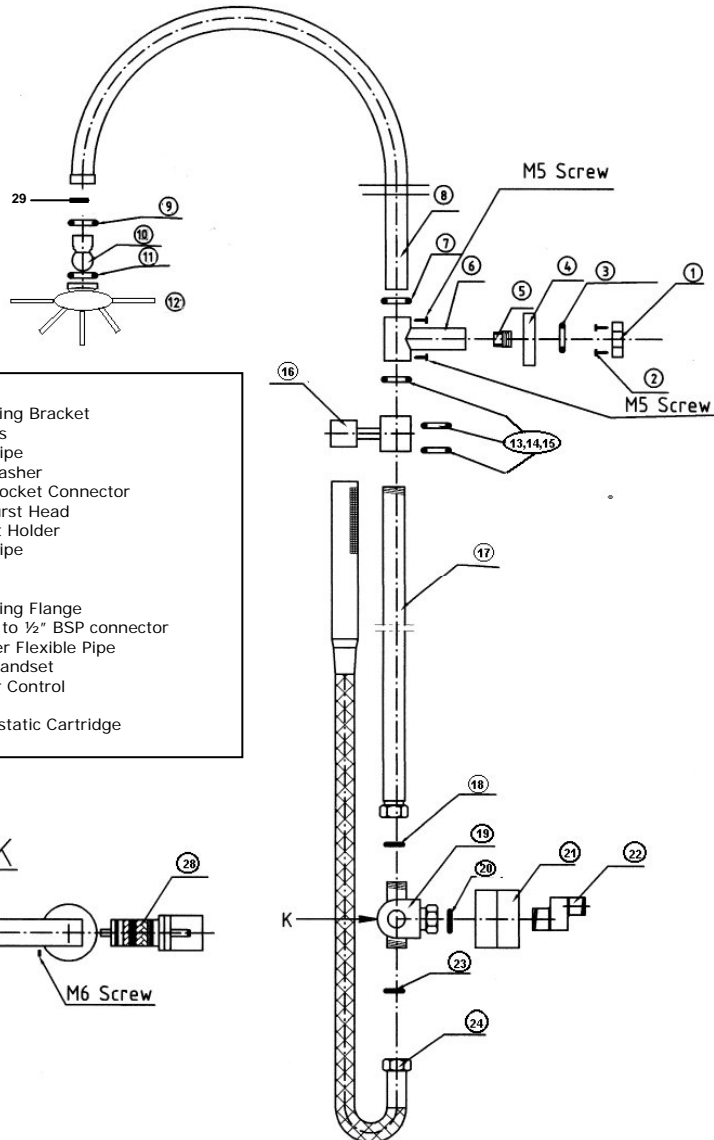

1, 2, 3, 4, 5	Fixings
6	Wall Fixing Bracket
7, 11, 13, 14, 15	'O' Rings
8,	Upper Pipe
9,	Filter Washer
10,	Ball & Socket Connector
12,	Cloudburst Head
16,	Handset Holder
17,	Lower Pipe
18, 20, 23, 29	Gaskets
19,	Valve
21,	Concealing Flange
22,	3/4" BSP to 1/2" BSP connector
24,	1.5meter Flexible Pipe
	Pencil Handset
25, 26	Divertor Control
27,	Valve
28,	Thermostatic Cartridge

Installation Guide

Helpline Number 01282 446789

1. Flush all pipework before installation
2. Connect the upper & lower pipes
3. Fit the cloudburst fixed head to the upper pipe.
4. Mark out the position of the pole on the wall.
5. Connect the flexible hose to the shower valve.
6. Attach the pole to the shower valve and fix to the wall.
7. Ensure the **hot connection is on the left, with the cold connection on the right.**
8. Check for water leaks

Pipe Centres

Without the 3/4" BSP to 1/2" BSP connector – 150 mm

With the 3/4" BSP to 1/2" BSP connector – this is variable between 120 mm minimum & 180 mm maximum.

Calibration Procedure

- 1.0 PRE-SET TEMPERATURE
 - 1.1 The valve temperature is pre-set at 38°C but on certain installations the setting may need to be adjusted.
- 2.0 CHECK TEMPERATURE & CALIBRATION
 - 2.1 Fully turn on valve water flow.
Note: Ensure the hot water is above 60°C.
 - 2.2 Set the Temperature Control Knob at the 38°C position & check the temperature of water from the handset – if not at 38°C continue below.
 - 2.3 Remove the centre cap & knob securing screw from the Temperature Control Knob.
 - 2.4 Fully remove the Temperature Control Knob.
 - 2.5 Relocate the Temperature Control Knob approximately 3mm back on to the splined shaft.
Note: Hold in position.
 - 2.6 If the pre-set temperature is too hot turn the Temperature Control Knob anti-clockwise to obtain the 38°C.
Note: Turn in small increments & allow 10 seconds between each to allow the cartridge to stabilise.
 - 2.7 When set at 38°C carefully remove the Temperature Control Knob from the splined shaft.
 - 2.8 Carefully relocate the Temperature Control Knob on the splined shaft aligning the 38° (on the knob) with the line on the fixed ring located on the valve body.
Note: Ensure that the knob is not rotated during this operation, as the temperature will be altered.
 - 2.9 Secure the Temperature Control Knob with the fixing screw & replace the centre cap.